

## 3RD FLOOR PROPOSED FLOOR PLAN

3/16" = 1'-0"

WINDOW SCHEDULE / DOOR SCHEDULE						
(NO.)	DESCRIPTION	UNIT SIZE (IN.)		GLASS	WIND PRESSURES	
		WIDTH	HEIGHT		POSITIVE +	NEGATIVE -
pp	FIXED WINDOW	9'-0"	5'-0"	IMPACT RESISTANT	29.83	32.60
qq	FIXED WINDOW	5'-0"	12'-0"	IMPACT RESISTANT	27.98	34.19
rr	FIXED WINDOW	5'-0"	8'-0"	IMPACT RESISTANT	32.90	33.02
ss	FIXED WINDOW	5'-0"	12'-0"	IMPACT RESISTANT	31.15	33.93
tt	FIXED WINDOW	6'-0"	2'-0"	IMPACT RESISTANT	32.60	35.38
uu	FIXED WINDOW	6'-0"	2'-0"	IMPACT RESISTANT	32.60	35.38
vv	HORIZONTAL SLIDING WINDOW	8'-0"	5'-0"	IMPACT RESISTANT	27.98	34.19
ww	FIXED WINDOW	5'-0"	8'-0"	IMPACT RESISTANT	32.53	33.28
xx	SLIDING GLASS DOOR	8'-0"	8'-0"	IMPACT RESISTANT	32.60	35.38
yy	SLIDING GLASS DOOR	10'-0"	8'-0"	IMPACT RESISTANT	32.16	34.93
zz	HORIZONTAL SLIDING WINDOW	8'-0"	5'-0"	IMPACT RESISTANT	31.15	33.93
1	FIXED WINDOW	6'-0"	2'-0"	IMPACT RESISTANT	32.60	35.38
2	SLIDING GLASS DOOR	8'-0"	8'-0"	IMPACT RESISTANT	32.60	35.38

### WALL LEGEND

- NEW 8" CBS WALL
- 6" WOOD BEARING WALL
- 4" INTERIOR PARTITION

### FLASHING NOTE

ALL WINDOW AND DOORS  
FLASHING TO COMPLY WITH 703.4 & R609.1  
CHAPTER 19-113 AND FBC 7TH EDITION 2020  
PRODUCT TREMCO VULKEM 116.

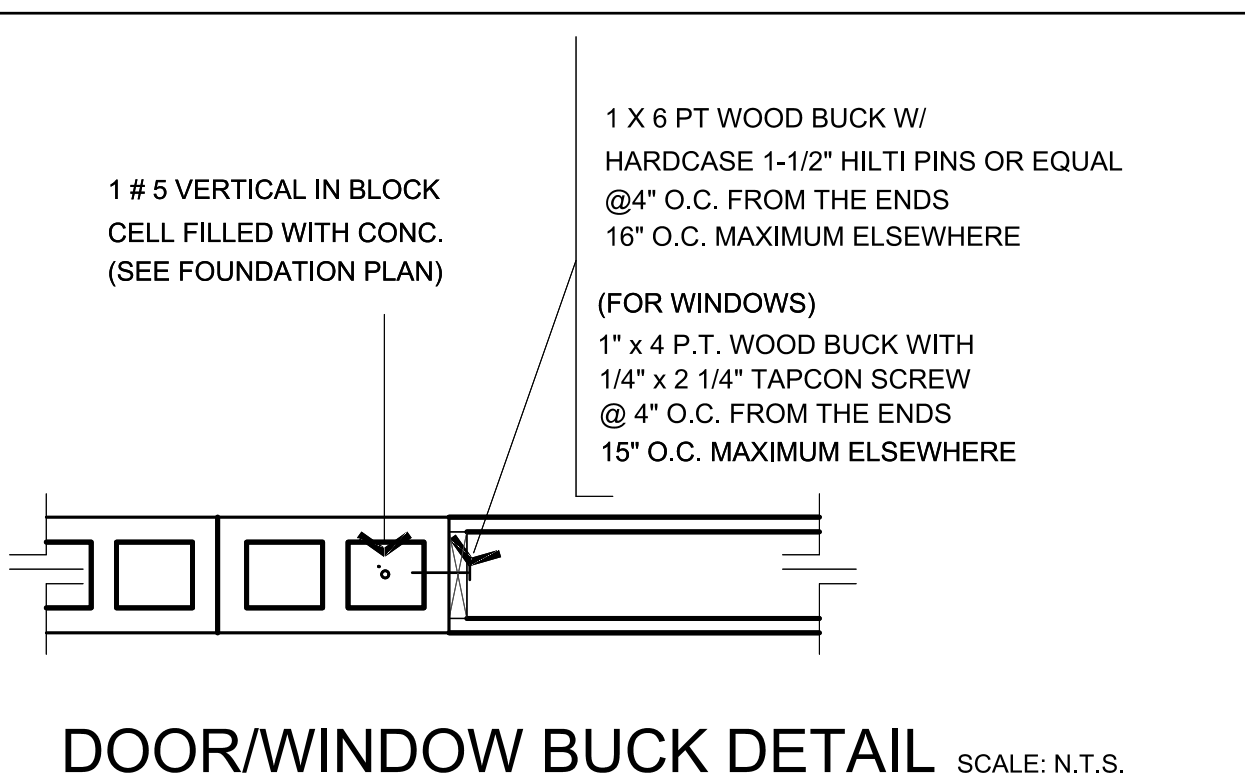

F2. FBC [F] 903.2 THE ENFORCING AGENCY WILL REQUIRE THAT ALL PROVISIONS FOR AN APPROVED AUTOMATIC SPRINKLER SYSTEM IN NEW BUILDING AND STRUCTURES BE PROVIDED IN THE LOCATIONS DESCRIBED IN SECTIONS 903.2.1 THROUGH 903.2.12.

## DESIGN CRITERIA

ALL STRUCTURAL ELEMENTS, EXPOSED TO WIND, HAVE BEEN DESIGNED PER THE GUIDELINES OF THE ASCE 7-16 FBC 2020 7TH EDITION NEC 2017 CODE  
WIND SPEED = 170 MPH 3 SEC GUST  
EXPOSURE C  
IMPORTANCE FACTOR = 1.00  
BUILDING CATEGORY- II  
Kd=0.85 FOR MWFRS WITH LOAD FACTORS  
ROOF HEIGHT IS 34'-11"  
PART. OPEN STRUCTURE  
LIVE LOAD .....30 PSF  
DEAD LOAD ..... 25 PSF